

FIREZERO

Party Wall Cavity Barrier + Series 3300+

Fire & Acoustic Party Wall DPC + Series 2500+

T shaped Party Wall Barrier for Masonry AND Framed Constructions

MDL Firezero T shaped Party Wall Cavity Barrier is manufactured from A1 non-combustible Rockwool insulation and encapsulated in a polythene sleeve.

This barrier has been designed to prevent fire penetration, reduce sound transmission and help maintain thermal integrity in external wall cavities at party wall junctions.

- ✓ Tested to BS EN1366-4:2021.
- ✓ 3rd Party Assessed & Accredited.
- ✓ Fire resistance up to 2 hours.
- ✓ Available for cavity widths 25 – 300mm.
- ✓ Suitable for vertical and roof applications.
- ✓ Satisfies Approved Document B.
- ✓ Satisfies Robust Detail Part E.
- ✓ Zero ODP and GWP.
- ✓ Polythene sleeved.
- ✓ Easy to install.



Product Options & Installation

Masonry Construction

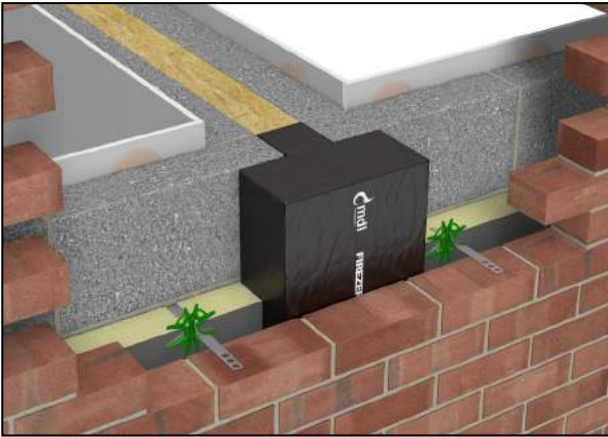

FIREZERO Party Wall Cavity Barrier+ (series 3300+) is designed to be compression fitted into the party wall and the cavity wall during the brickwork process, no additional fixings are required.

The barrier is designed to fully fill the outer cavity and close off the party wall to provide a thermal, fire and acoustic seal.

It is essential to ensure the correct size barrier has been selected for the cavity width, and a minimum of 10mm compression is achieved upon completion.

Any cavity insulation must be cut back to ensure correct compression of the barrier is maintained between the inner and outer leaf.

The barrier should bear equally onto each leaf of the party wall.

Attention must be paid at joints to ensure they are tightly butt jointed and maintain a continuous fire seal.

If any gaps are present or the Party Wall Cavity Barrier is damaged in any way this could result in a reduction of the stated performance.

Masonry Construction with DPC



Fire & Acoustic Party Wall DPC+ (series 2500+) is also available and features an integral DPC to provide further protection against driven rain.

This barrier can also be used at the head of a blockwork party wall where mineral wool fire stopping is required for building regulations, e.g. a run of terraced housing. In this application, it is simply compression fitted into the party wall and abuts the roofing membrane.

Framed Construction



The application and installation method within framed constructions is the same as with masonry.

Product Selection

To suit cavity width of		Barrier Dimensions (mm)					Series 3300+	Series 2500+		Fire Rating Vertical	
Party Wall (mm)	External Wall (mm)	A	B	C	D	Length	Product Code	Product Code	DPC Width (mm)	Integrity	Insulation
40-50	91-100	65	65	110	250	1200	3300/TB/50/100	2500/TB/50/100	337	120	60
40-50	101-110	65	65	120	250	1200	3300/TB/50/110	2500/TB/50/110	337	120	60
40-50	111-120	65	65	130	250	1200	3300/TB/50/120	2500/TB/50/120	337	120	60
40-50	121-130	65	65	140	250	1200	3300/TB/50/130	2500/TB/50/130	337	120	60
40-50	131-140	65	65	150	250	1200	3300/TB/50/140	2500/TB/50/140	337	120	60
40-50	141-150	65	65	160	250	1200	3300/TB/50/150	2500/TB/50/150	337	120	60
66-75	91-100	85	100	110	250	1200	3300/TB/75/100	2500/TB/75/100	337	90	60
66-75	101-110	85	100	120	250	1200	3300/TB/75/110	2500/TB/75/110	337	90	60
66-75	111-120	85	100	130	250	1200	3300/TB/75/120	2500/TB/75/120	337	90	60
66-75	121-130	85	100	140	250	1200	3300/TB/75/130	2500/TB/75/130	337	90	60
66-75	131-140	85	100	150	250	1200	3300/TB/75/140	2500/TB/75/140	337	90	60
66-75	141-150	85	100	160	250	1200	3300/TB/75/150	2500/TB/75/150	337	90	60
91-100	91-100	110	100	110	250	1200	3300/TB/100/100	2500/TB/100/100	337	90	60
91-100	101-110	110	100	120	250	1200	3300/TB/100/110	2500/TB/100/110	337	90	60
91-100	111-120	110	100	130	250	1200	3300/TB/100/120	2500/TB/100/120	337	90	60
91-100	121-130	110	100	140	250	1200	3300/TB/100/130	2500/TB/100/130	337	90	60
91-100	131-140	110	100	150	250	1200	3300/TB/100/140	2500/TB/100/140	337	90	60
91-100	141-150	110	100	160	250	1200	3300/TB/100/150	2500/TB/100/150	337	90	60
121-130	91-100	140	100	110	250	1200	3300/TB/125/100	2500/TB/125/100	337	90	60
121-130	101-110	140	100	120	250	1200	3300/TB/125/110	2500/TB/125/110	337	90	60
121-130	111-120	140	100	130	250	1200	3300/TB/125/120	2500/TB/125/120	337	90	60
121-130	121-130	140	100	140	250	1200	3300/TB/125/130	2500/TB/125/130	337	90	60
121-130	131-140	140	100	150	250	1200	3300/TB/125/140	2500/TB/125/140	337	90	60
121-130	141-150	140	100	160	250	1200	3300/TB/125/150	2500/TB/125/150	337	90	60
141-150	91-100	160	120	110	250	1200	3300/TB/150/100	2500/TB/150/100	337	90	60
141-150	101-110	160	120	120	250	1200	3300/TB/150/110	2500/TB/150/110	337	90	60
141-150	111-120	160	120	130	250	1200	3300/TB/150/120	2500/TB/150/120	337	90	60
141-150	121-130	160	120	140	250	1200	3300/TB/150/130	2500/TB/150/130	337	90	60
141-150	131-140	160	120	150	250	1200	3300/TB/150/140	2500/TB/150/140	337	90	60
141-150	141-150	160	120	160	250	1200	3300/TB/150/150	2500/TB/150/150	337	90	60

Ordering:

Select the product code for the required product based on the cavity widths of your construction.

For reference, the barrier dimensions shown in the table are oriented as per this model

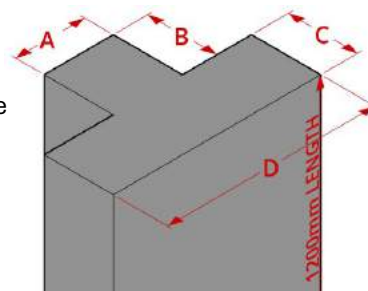



Technical Data

FIREZERO Party Wall Cavity Barrier+ and Fire & Acoustic Party Wall DPC+ have been independently tested at Warringtonfire to BS EN 1366-4:2021 utilising the new 10:1 ratio giving the barriers a fire rating up to 120 minutes.

IFC Certification undertook further assessments and deemed the product suitable for use with various boards on both timber and steel framing systems. Timber based boards must have a minimum density of 600kg/m³. Any other carrier board must have a minimum classification of A2 – s1 d0 in accordance with BS EN 13501-2. Minimum permissible thickness of boards is 9mm.

Meets Approved Document E of the Building Regulations relating to sound transmission.

Complies with Building Regulations in England, Wales, Scotland and Northern Ireland.

Environmental

Manufactured using stonewool slab which is 97% recyclable and classified as ZERO ODP and GWP. All barriers are packed in polythene bags and cardboard sleeves for protection and stability during transit. Both the polythene bags and cardboard sleeves are widely recyclable.

Storage

Party Wall Cavity Barrier+ should be stored dry and out of direct sunlight.

COSHH

MDL are committed to supplying products which are both safe to install and manufactured in a safety conscious environment. We continue to assess all components used in our products to meet all the requirements of the Substances Hazardous to Health Regulations (COSHH). COSHH datasheets are available upon request for all MDL products and components used in our manufacturing processes.

Disclaimer:

The information provided in this datasheet is intended for general guidance purposes only and does not constitute professional advice. Users are advised to conduct their own tests and evaluations to determine the suitability of the product for their specific application to meet relevant fire safety standards. Use of all products should be approved by the appropriate designer under CDM 2015 regulations.

MDL Insulations Ltd. shall not be liable for any loss or damage, including but not limited to indirect or consequential loss or damage, or any loss or damage whatsoever arising from the use of this product or reliance on the information provided in this datasheet.

It is the responsibility of the user to ensure proper installation, maintenance, and compliance with relevant guidelines. By using this product, the user agrees to accept all risks associated with its use and releases the manufacturer from any liability whatsoever.



T: 01543 450311

F: 01543 450885

E: sales@mdlinsulations.co.uk

W: www.mdlinsulations.co.uk

Villa Works, 1 Plant Lane Business Park, Burntwood, Staffs, WS7 3GN